

see also A-44-186

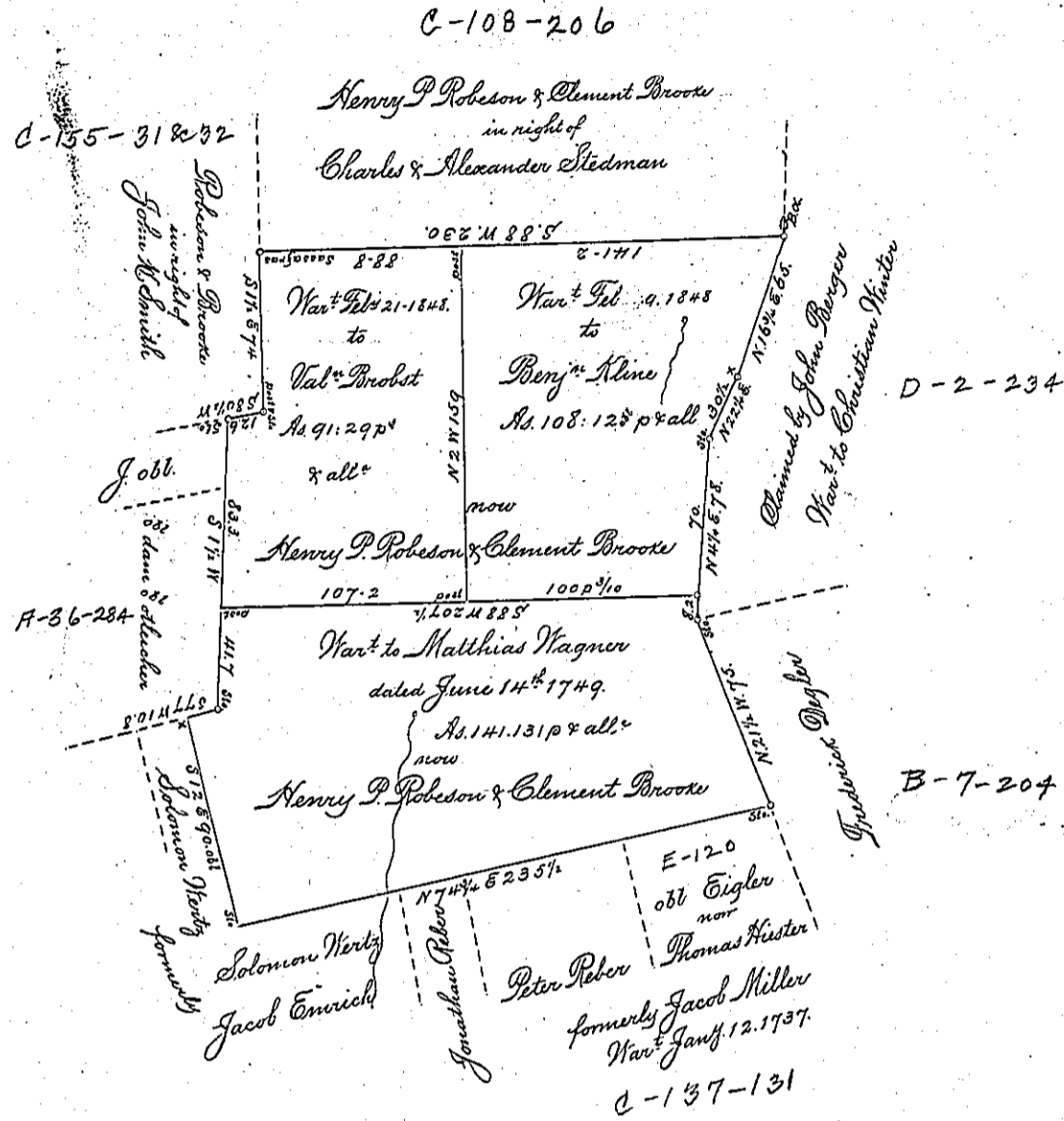

Situate in Upper Tulpehocken township Berks County. The two surveys in the name of Val. Probst & Benj. Kline were surveyed on the Warrants above named and in pursuance of an Order of the Board of Property of the 3<sup>d</sup> of Sept<sup>r</sup> 1851. relocated. The survey in the name of Matthias Wagner was surveyed pursuant to his Warrant as above named. Now the property of Henry P. Robeson & Clement Brooke.

Surveyed September 9, 1851.  
 Certified by Aug<sup>r</sup> J. Bertolt,  
 County Surveyor.

Returned to J. Porter Brawley Esquire }  
 Surveyor Genl. of Penna. }  
 (P. mail Sept<sup>r</sup> 26, 1851.)

IN TESTIMONY that the above is a copy of the original remaining on file in the Department of Internal Affairs of Pennsylvania, made conformably to an Act of Assembly approved the 16th day of February, 1833, I have hereunto set my Hand and caused the Seal of said Department to be affixed at Harrisburg, this

second day of August 1898.

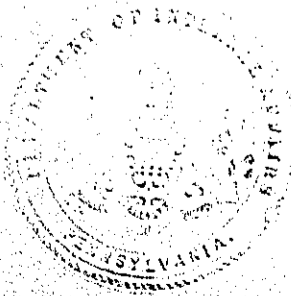

James W. Little  
 Secretary of Internal Affairs.